

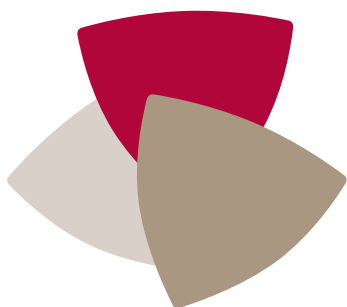

GSL PRODUCTS CATALOGUE



RB-DOORS



RB Technical Catalogue

TABLE OF CONTENTS



About RB-DOORS	Page 4
Research, Development & Standards	Page 5
Residential Security Door Model 740	Pages 6-7
Residential Security Door Model 744	Pages 8-9
Residential Security Door Series Mix&Match	Pages 10-11
Designed Security Doors	Pages 12-13
Galdiator® System	Pages 14-15
Forced Entry Resistant Door Model FE5	Pages 16-17
Forced Entry Resistant Door Model FE15	Pages 18-19
Forced Entry Resistant Door Model FE60	Pages 20-21
Bullet Proof Door Model 769	Pages 22-23
30 Min Single/Double Leaf Fire Door Model FW30	Pages 24-25
45 Min Single/Double Leaf Fire Door Model FWB	Pages 26-27
90 Min Single/Double Leaf Fire Door Model FW90	Pages 28-29
Industrial Doors	Pages 30-31
Interior Door	Pages 30-31



RB-DOORS

INNOVATIVE SECURITY



RB-DOORS (Rav-Bariach (08) industries ltd) was founded in 1973 and with the development of the unique multi-bolt locking system, the strength and durability of the steel entry door and the ever-evolving designs, the world of security entrance doors was transformed.

Since inception, RB-DOORS set forth to lead the door industry, establishing new standards for security, quality, visionary thinking and cutting edge technology.

The constant pursuit of innovation has led to the registration of patents and trademarks, both in Israel and internationally and an impressive record supplying **over 4 million doors** in Israel and abroad. Our commitment to innovation is also applied to technology, state of the art production lines, development of advanced lock mechanisms, creative and meticulous design of the steel doors and more.

RB-DOORS has specialized in the development and manufacturing of superior High Security products for the protection of property and life, making RB-DOORS an international leader in the manufacturing and marketing of steel security doors for every need, worldwide.



RESEARCH, DEVELOPMENT & STANDARDS

RB-DOORS Research and Development department is one of the company's most important departments, serving as a source of inspiration and a role model. Over the years since the establishment of RB-DOORS R&D Department, a large number of new products have been developed in different divisions including security entry doors, interior doors, high security doors, Forced Entry doors and advanced locking solutions. The developments set new standards and serve as leading models for other companies in the industry worldwide.

RB-DOORS develops and manufactures highest quality security solution products which comply to the strict demands of Israeli Security Standards and international standards.



RESIDENTIAL SECURITY DOOR

MODEL 740/540

The 740 model is RB's most popular residential steel security entry door. The 740 type doors are manufactured in RB's state of the art production line using the most advanced technologies and exercising strict product quality assurance.

TECHNICAL SPECIFICATIONS

GENERAL DESCRIPTION

- The high security steel door is made of two 1.25 mm thick galvanized steel sheets with vertical and horizontal steel bars placed between the sheets, reinforcing the door leaf for optimum security structure.
- The door leaf thickness is 50 mm.
- The door filling: polystyrene foam, cardboard honeycomb or rock wool.
- Peripheral rubber seal.
- Telescopic bottom insert for easy door height adjustment.
- Door leaf weight is ~50kg.

LOCKING SYSTEM

- A 4-way door lock model RB507, with four 10 mm front bolts and spring - loaded latch.
- One bottom reinforcement lock mechanism.
- Upper 13 mm bolts operated by the lock. Hook type rear - fixed bolt.
- RB's High Security cylinder.
- Improved cylinder protector preventing picking and drilling as well as forcing of the lock cylinder.
- Security cover plates on both sides of the locking case.

***also available with the unique high security Gladiator® system**

FRAME:

- Construction frame made of 1.25/1.5 mm thick galvanized steel. The frame with anchors is mounted and cemented directly into the wall.
- Cover frame made of 1.25/1.5 mm thick steel for installation on existing wood or metallic frames.

DOOR FINISHES

- PVC finish.
- Powder coated.

DIMENSIONS

- Max Door Height – 2,400 mm
- Max Door Width – 1,200 mm (single leaf)

Door is available in Single or Double - leaf variants.



DOOR FINISHES

RAL Color Catalog



PVC Coating



Additional door finishes available

* The colors are for illustration purposes only. The final color may vary.



RESIDENTIAL SECURITY DOOR | MODEL 740

TECHNICAL DRAWINGS

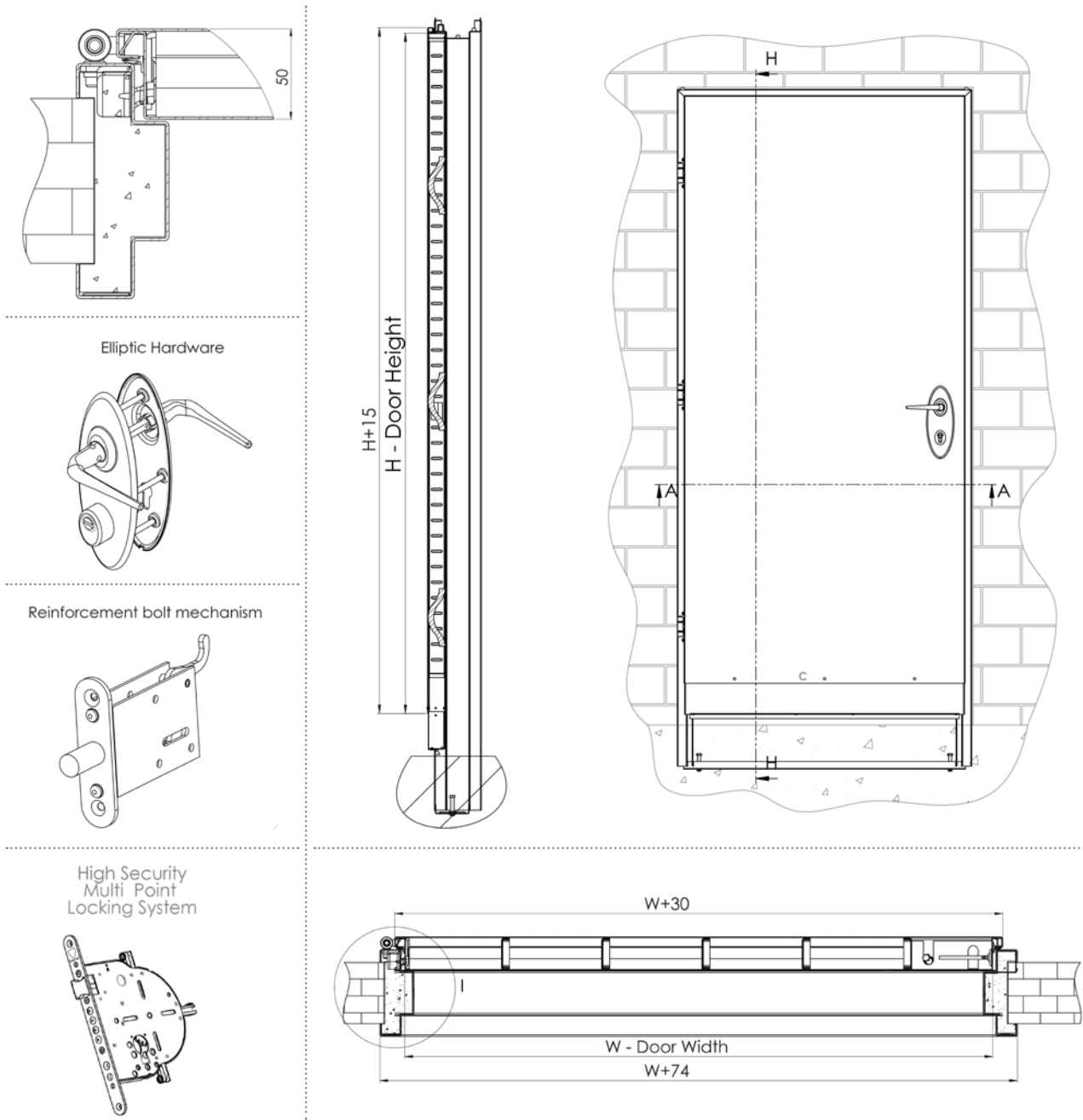

RESIDENTIAL SECURITY DOOR

MODEL 744

The 744 model is designed for a higher residential security level. The 744 type doors are manufactured in RB's state of the art production line using the most advanced technologies and exercising strict product quality assurance.

TECHNICAL SPECIFICATIONS

GENERAL DESCRIPTION

- The Residential security steel door is made of two 1.25 mm thick galvanized steel sheets with vertical and horizontal steel bars placed between the sheets, reinforcing the door leaf for optimum security structure.
- The door leaf thickness is 50 mm.
- The door filling: polystyrene foam, cardboard honeycomb or rock wool.
- Peripheral rubber seal.
- Telescopic bottom insert for easy door height adjustment.
- Door leaf weight is ~50kg.

LOCKING SYSTEM

- A 4-way door lock model RB507, with four 10 mm front bolts and spring - loaded latch.
 - Two hook type reinforcement mechanisms.
 - Upper 13 mm bolts operated by the lock. Hook type rear fixed bolt.
 - RB's High Security cylinder.
 - Improved cylinder protector preventing picking and drilling as well as forcing of the lock cylinder.
 - Security cover plates on both sides of the locking case.
- *also available with the unique high security Gladiator® system

FRAME

- Construction frame made of 1.25/1.5 mm thick galvanized steel. The frame with anchors is mounted and cemented directly into the wall.
- Cover frame made of 1.25/1.5 mm thick steel for installation on existing wood or metallic frames.

DOOR FINISHES

- PVC finish.
- Powder coated.

DIMENSIONS

- Max Door Height – 2,400 mm
- Max Door Width – 1,200 mm (single leaf).

Door is available in Single or Double - leaf variants.



DOOR FINISHES

RAL Color Catalog



PVC Coating



Additional door finishes available

* The colors are for illustration purposes only. The final color may vary.

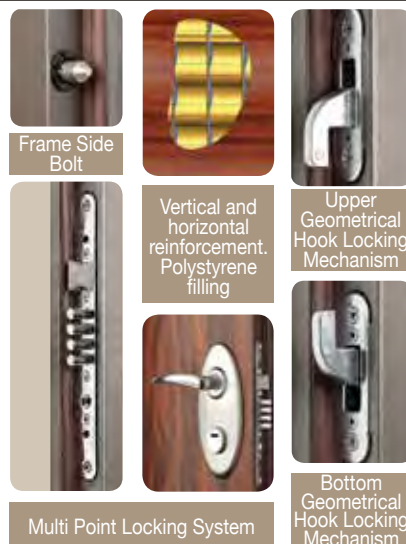

RESIDENTIAL SECURITY DOOR | MODEL 740

TECHNICAL DRAWINGS

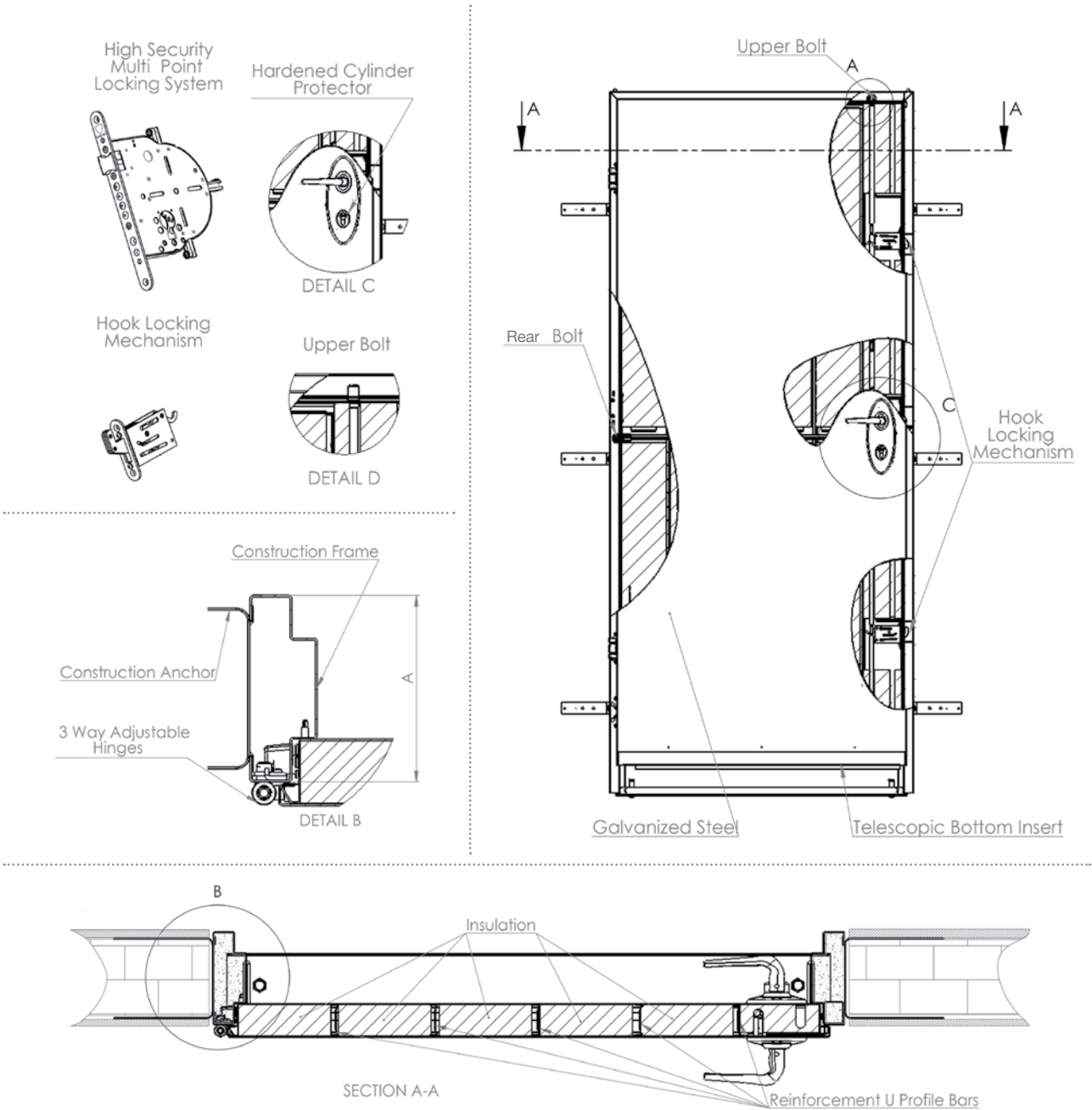

RESIDENTIAL SECURITY DOOR

SERIES MIX&MATCH

The Mix&Match decorative security steel door series incorporates the latest technologies, security systems and designs for residential entrances.

TECHNICAL SPECIFICATIONS

GENERAL DESCRIPTION

- The door leaf is made of two 1.25 mm thick galvanized steel sheets with vertical and horizontal steel reinforcements for optimal security structure.
- The door leaf is filled with polystyrene foam or Rockwool and honeycomb for thermal and acoustic insulation.
- The door leaf is 50 mm thick (not including decorative panel).
- Peripheral aluminum profile to fit Mix&Match series decorative panel.
- Mix&Match panel thickness is 4 mm and may be installed on one or both sides of the door.
- The door includes a telescopic bottom insert to enable easy adjustment during installation.

LOCKING SYSTEM

- A 4-way door lock model RB507, with four 10 mm diameter front bolts and spring - loaded latch.
- One bottom hook reinforcement mechanism.
- Upper 13 mm bolts operated by the lock. Special rear hook fixed bolt.
- RB's High Security cylinder.
- Improved cylinder protector preventing picking and drilling as well as forcing of the lock cylinder.
- Available with the unique high security Gladiator® lock system.

FRAME

- Construction frame made of 1.25/1.5 mm thick galvanized steel. The frame is mounted directly on the wall with anchors and cemented to the building structure.
- Cover frame made of 1.25/1.5 mm thick steel for installation on existing wood or metal frames.

DOOR FINISHES

- Outer side – Mix&Match decorative panel.
- Inner side - Powder Coating, or Mix&Match decorative panel.

DIMENSIONS

- Door Width: 300-1,080 mm (single leaf).
- Door Max Height: 2400 mm.
- Telescopic bottom insert height not included.

Mix&Match doors are available in single or double leaf configurations.



THE NEW MIX&MATCH FINISHES

The series boasts a wide selection of innovative finishes new to the door industry and exclusive to RB-Doors: Faux Fabric Finish, Shiny Finish for a Modern Look, Faux Wood Finish and more!

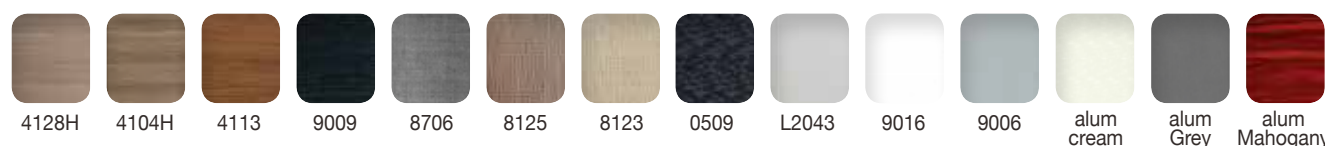

* The new design is based on the standard door structure (series 8+7)
* The colors are for illustration purposes only. The final color may vary.



RESIDENTIAL SECURITY DOOR | SERIES MIX&MATCH

MIX&MATCH SERIES MODELS



MODEL A
5 equal sections, peripheral aluminum profile and horizontal aluminum striping in either black or nickel. (6 sections for taller doors)



Model B
5 equal sections including a middle section in a natural aluminum finish with lock, peripheral aluminum profile and horizontal aluminum striping in either black or nickel. (6 sections for taller doors)



Model C
3 equal sections, peripheral aluminum profile and horizontal aluminum striping in either black or nickel.



Model D
Flat surfaced door with selected finish. The interior side of the door is supplied with a painted finish.

High Security Multi Point Locking System

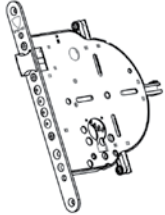

Hook Locking Mechanism

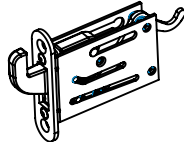

Construction Frame

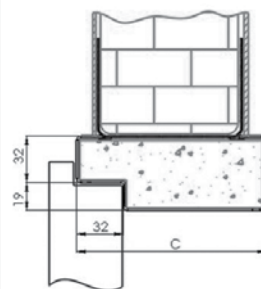

Gypsum Wall Frame

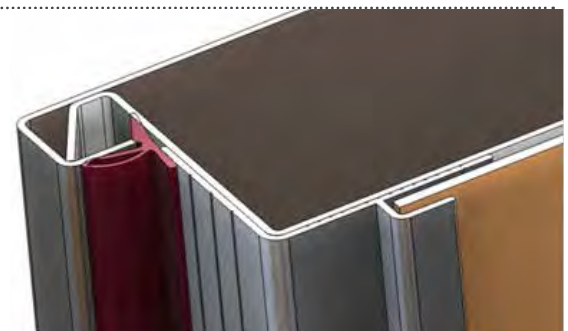
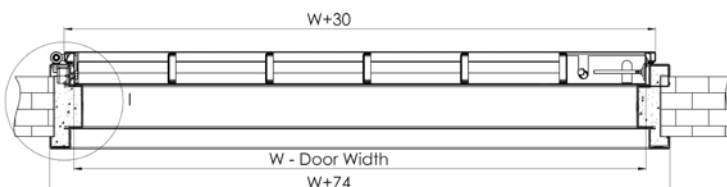
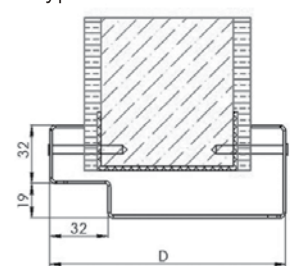

RESIDENTIAL SECURITY DOOR

SERIES DESIGNED SECURITY DOORS

RB-DOOR'S designed and stylish security steel door incorporates the latest technologies, security systems and designs for residential entrances.

TECHNICAL SPECIFICATIONS

GENERAL DESCRIPTION

- The door leaf is made of two 1.25 mm thick galvanized steel sheets with vertical and horizontal steel reinforcements for optimal security structure.
- The door leaf is filled with Rockwool or honeycomb for thermal and acoustic insulation.
- The door leaf is 50 mm thick.
- Various designs and finishes.
- The door includes a telescopic bottom insert to enable easy adjustment during installation.

LOCKING SYSTEM

- A 4-way door lock model RB507, with four 10 mm diameter front bolts and spring-loaded latch.
- One bottom hook reinforcement mechanism.
- Upper 13 mm bolts operated by the lock. Special rear hook fixed bolt.
- RB's High Security cylinder.
- Improved cylinder protector preventing picking and drilling as well as forcing of the lock cylinder.
- Available with the unique high security Gladiator® lock system.

FRAME

- Construction frame made of 1.25/1.5 mm thick galvanized steel. The frame is mounted directly on the wall with anchors and cemented to the building structure.
- Cover frame made of 1.25/1.5 mm thick steel for installation on existing wood or metal frames.

DOOR FINISHES

- Powder coating.
- Wood finish.
- Various windows.

DIMENSIONS

- Door Width: 300-1,080 mm (single leaf).
- Door Max Height: 2400 mm.
- Telescopic bottom insert height not included.

Doors are available in single or double leaf configurations.



DOOR FINISHES & DESIGNS

RAL Color Catalog



Available door designs



*Additional door finishes & designs available

*The colors are for illustration purposes only. The final color may vary. *The new design is based on the standard door structure (series 8+7)



RESIDENTIAL SECURITY DOOR | DESIGN

TECHNICAL DRAWINGS

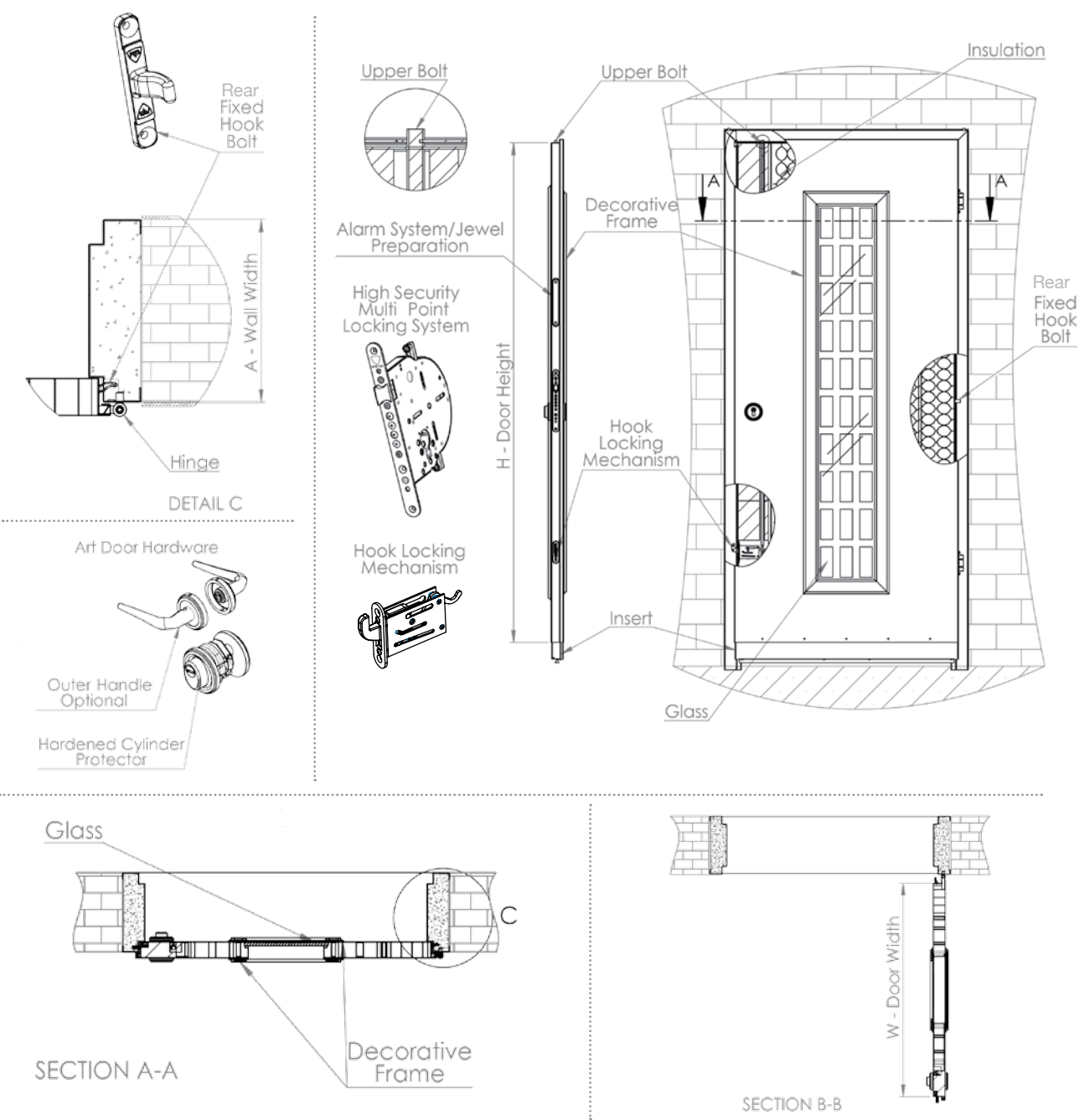

STEEL SECURITY DOOR

THE GLADIATOR® SYSTEM

To ensure the security of their customers, RB-DOORS provide the most advanced locking systems.

The Gladiator® system is RB-DOORS proprietary locking mechanism. It is one of the most advanced locking systems available, directing 3 hook-like bolts into the jamb, making it extremely difficult to tamper with the door.

This hook is a unique addition to the rest of the (already existing) six or more existing locking bolts in the door.

TECHNICAL SPECIFICATIONS

GLADIATOR® LOCK AND HARDWARE:

- The door is equipped with a unique 4-way lock (model RB507 or RB606), having four 10 mm (0.393")/18 mm (0.709") front bolts.
- The lock also activates upper and rear 13 mm (0.511") bolts.
- Unique hook mechanisms, located above and below the main lock, and 2 fixed hook bolts in the hinge side are attaching the door Leaf to the frame applying high security structure
- High security RB cylinder.
- An improved cylinder protector, preventing picking and drilling as well as forcing of the lock cylinder.
- In a locked position, geometric locking is achieved. • The bolts are independent which means that forcing one bolt will not affect the others and will not cause the opening of the lock system by pushing or applying pressure on a bolt head.

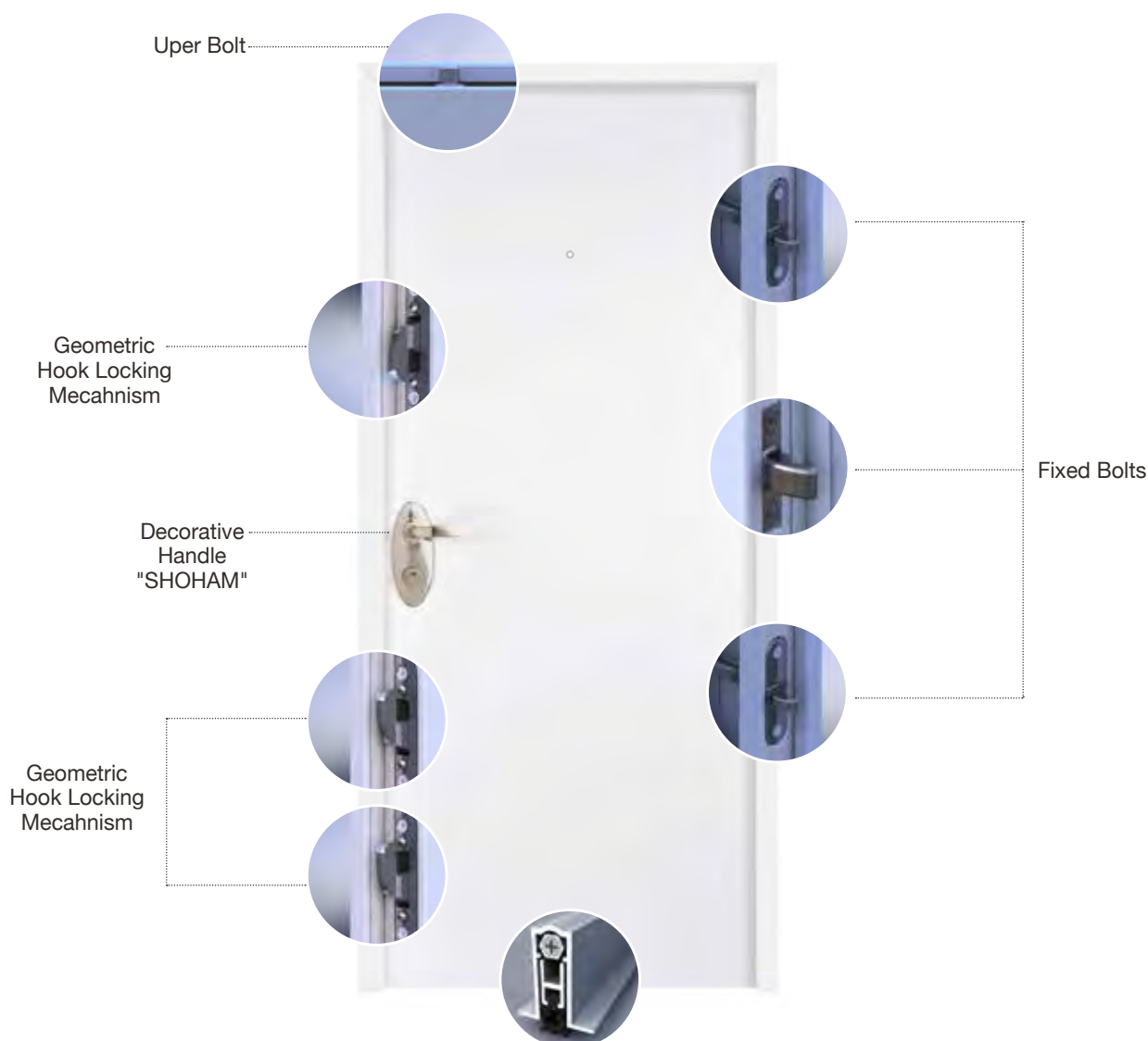

STEEL SECURITY DOOR | THE GLADIATOR® SYSTEM

DOOR FINISHES



*Additional door finishes & designs available

* The colors are for illustration purposes only. The final color may vary. *The new design is based on the standard door structure (series 8+7)

TECHNICAL DRAWINGS

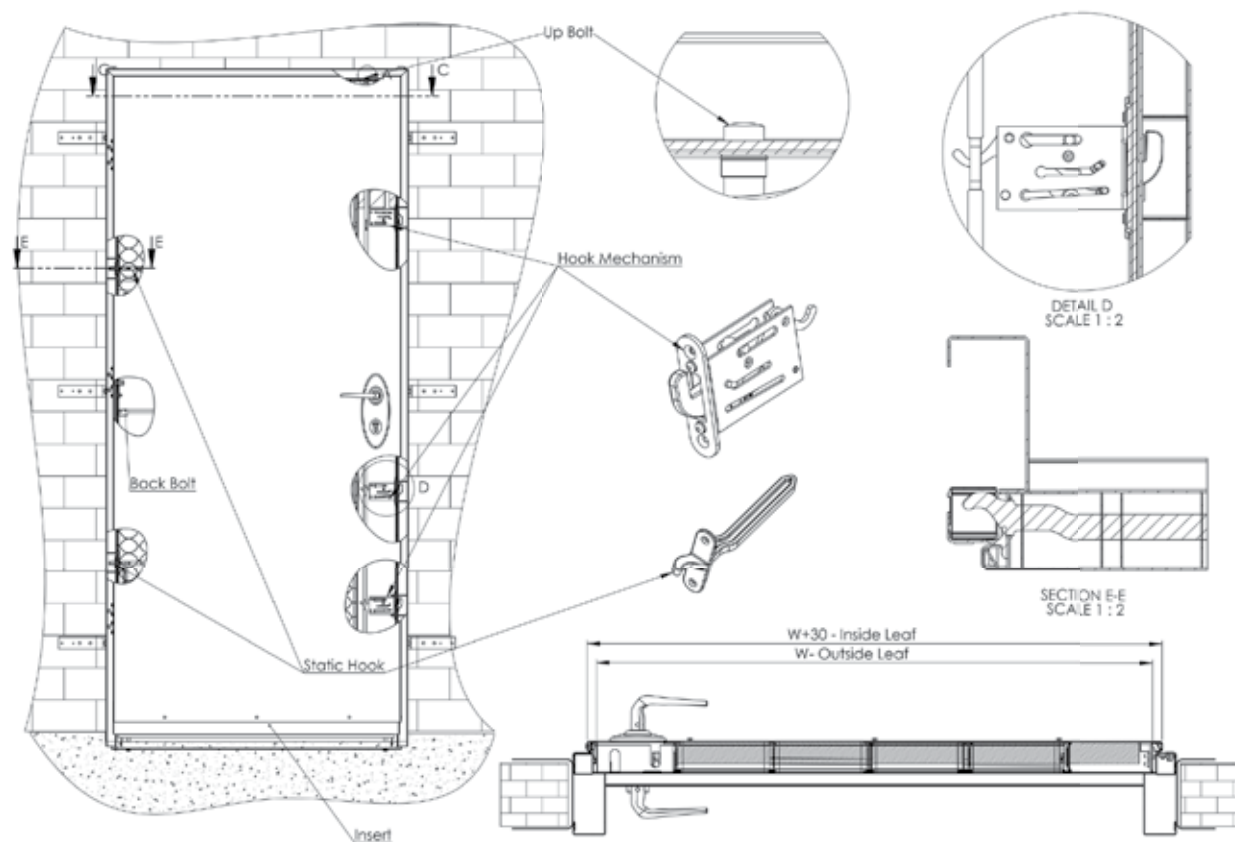

FORCED ENTRY RESISTANT DOOR

MODEL FE 5

The Forced Entry Resistant Door Model FE5 is manufactured by RB-DOORS according to the highest production standards and in compliance with special regulations. The door is suitable for all building types – residential, commercial, institutional and for special purposes.

TECHNICAL SPECIFICATIONS

GENERAL DESCRIPTION

- The door leaf is constructed of two galvanized steel sheets (thickness 1.25mm) together with 0.8 hardened steel plate attached to the sheet.
- The door leaf is reinforced by horizontal and vertical steel bars which together with the casing, create a high security structure.
- Five Hook type locking mechanisms and four fixed rear security bolts.
- Four concealed hinges.
- Four way mortise lock.
- Door leaf thickness: 50mm.
- The door leaf is pre-hung to the frame.
- Door leaf weight ~ 80 kg.
- Outward opening door.

HARDWARE AND ACCESSORIES

- RB High security cylinder.
- Hardened drill resistant cylinder protector with a rotating disc.
- Security cover plates on both sides of the locking case.
- Four way mortise lock as standard and Electronic monitoring function (lock \ un-lock) – optional.
- Motorized cylinder with mechanic back-up - optional.

FRAME

- Construction or Cover special FE5 frame.

DOOR FINISHES

- PVC finish.
- Powder coating.
- 4 mm decorative panels.

DIMENSIONS

- Door Height: 1,960 – 2,370 mm.
- Door width: 700-1,100 mm.

Double door is available in custom made orders.



5 Geometrical
Hook Locking
Mechanism

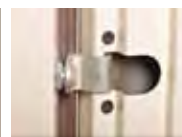

4 concealed
hinges

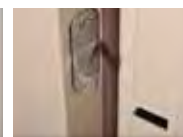

fixed rear
security
bolt

DOOR FINISHES

RAL Color Catalog



PVC Coating



Decorative panels

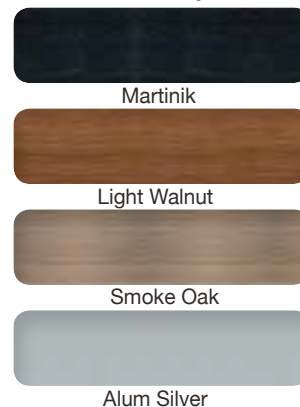

Additional door finishes available

* The colors are for illustration purposes only. The final color may vary.



FORCED ENTRY RESISTANT DOOR | MODEL FE 5

TECHNICAL DRAWINGS

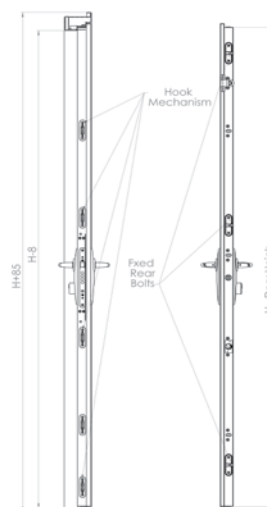
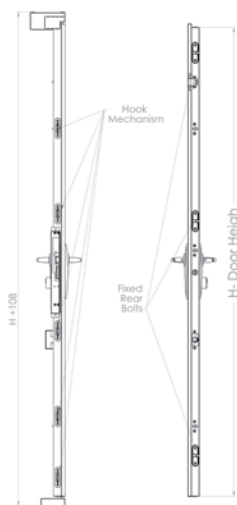
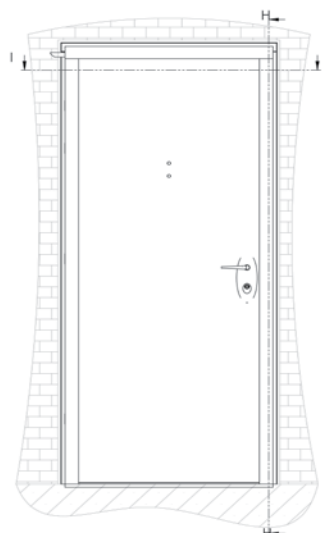
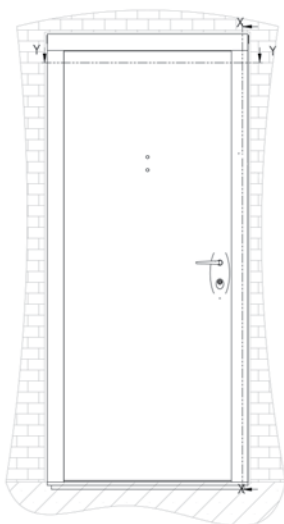

Cover Frame



Construction Frame

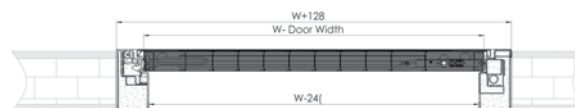

FORCED ENTRY RESISTANT DOOR

MODEL FE 15

The Forced Entry Resistant Door Model FE15 is manufactured by RB-DOORS according to the highest production standards and in compliance with special regulations. The door is suitable for all building types – residential, commercial, institutional, security areas and for special purposes.

TECHNICAL SPECIFICATIONS

GENERAL DESCRIPTION

- The door leaf is constructed of two galvanized steel sheets (thickness 1.25mm).
- The door leaf is reinforced by horizontal and vertical steel bars welded to the steel sheets and an inner metal reinforcement plate creating a high security door structure.
- A four way central mortise lock with five reinforcement locking mechanisms, four fixed rear security bolts and four concealed hinges highly secure the door against forced entry.
- Door leaf thickness: 50 mm.
- The door leaf is pre-hung to the frame.
- Door leaf weight ~ 85 kg.
- Outward opening door only.
- The FE15 door is available in UL 60 min fire rating according to UL10b.

HARDWARE AND ACCESSORIES

- RB's High security cylinder.
- Hardened drill resistant cylinder protector with a rotating disc.
- Security cover plates on both sides of the locking case.
- Four way mortise lock with Electronic monitoring function (lock/un-lock) – optional.
- Motorized cylinder with mechanic back-up- optional.

FRAME

- Special FE15 Construction or Cover frame are available.

DOOR FINISHES

- PVC finish.
- Powder painted.
- 4 mm decorative panels.

DIMENSIONS

- Door Height : 1,960 – 2,370 mm.
- Door width : 700-1,100 mm.

Double door is available in custom made orders.

DOOR FINISHES

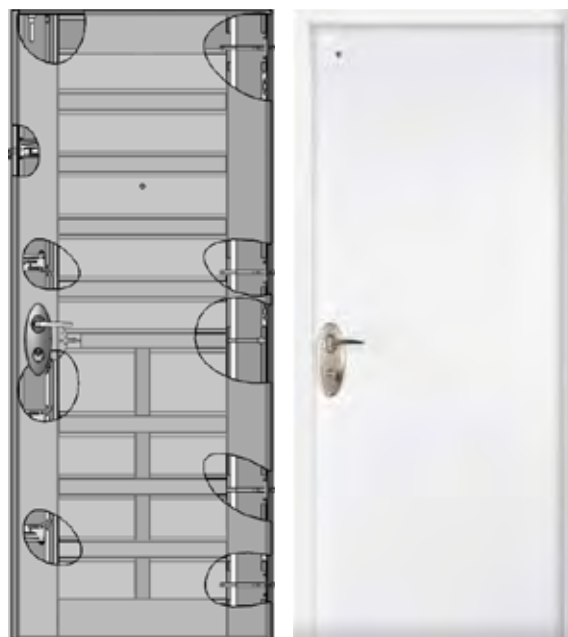

5 reinforcement
Locking
Mechanism



4 concealed
hinges

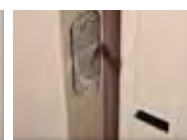

fixed rear
security bolt

RAL Color Catalog



PVC Coating



Decorative panels

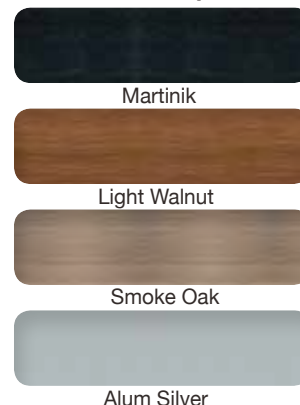

Additional door finishes available

* The colors are for illustration purposes only. The final color may vary.



FORCED ENTRY RESISTANT DOOR | MODEL FE 15

TECHNICAL DRAWINGS

With Cover Frame

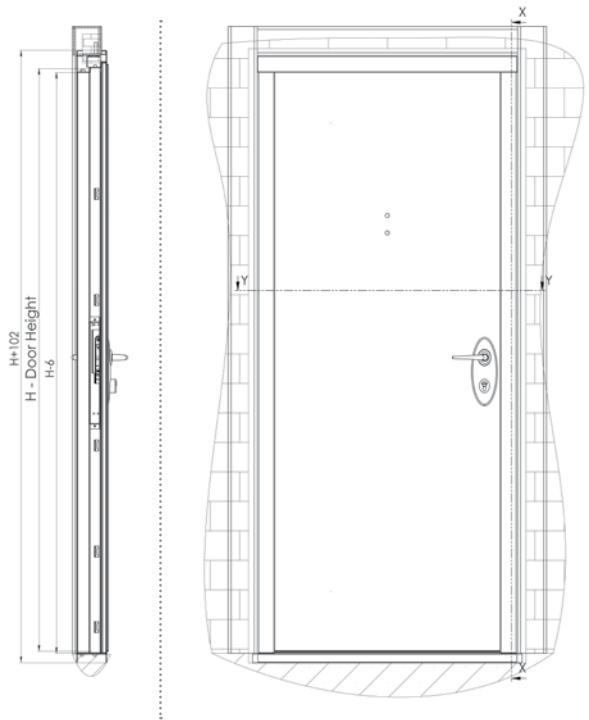

With Construction Frame

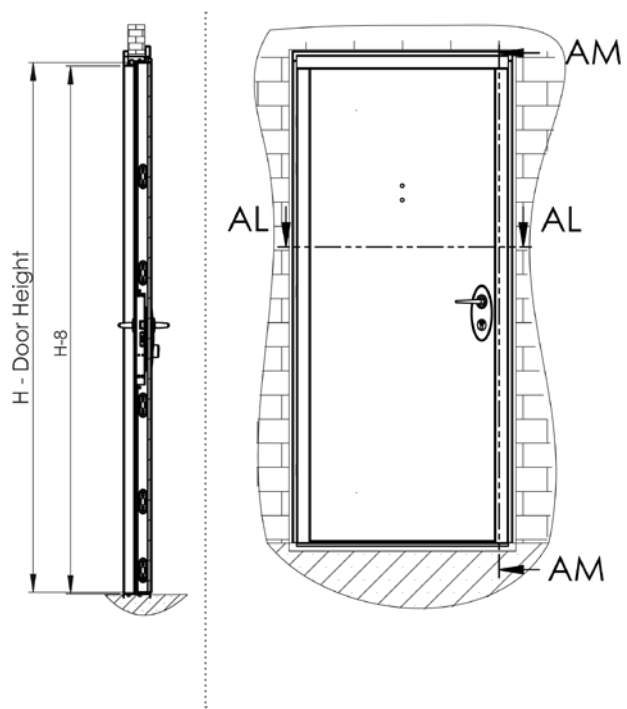

Construction Frame

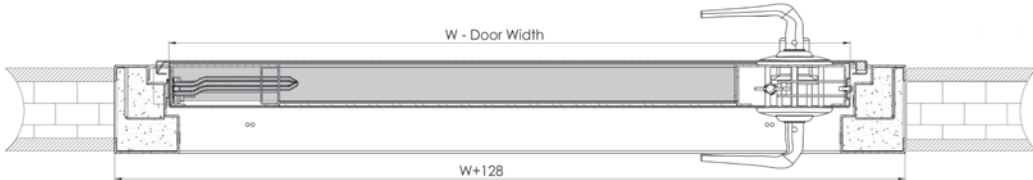

Cover Frame

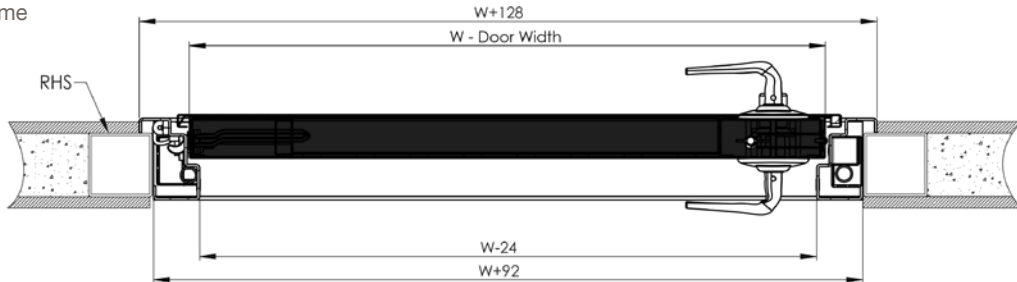

FORCED ENTRY RESISTANT DOOR

MODEL FE 60

The Blast, Ballistic & Forced Entry Resistant Steel Door model FE60 is manufactured by RB-DOORS according to the highest production standards and in compliance with special regulations of the Israeli Ministry of Defence. The FE60 is a Ballistic Resistant Steel Door, a security door providing the highest protection against burglaries as well as against military rifle and submachine attacks.

TECHNICAL SPECIFICATIONS

GENERAL DESCRIPTION

- The door leaf is constructed of two galvanized steel sheets (thickness 1.25mm) with a ballistic resistant plate installed between them.
- The door leaf is reinforced with transversal steel bars set across the leaf between the casings.
- A fourteen-point locking system and four specially designed high resistant hinges provide maximum protection against forced entry and high blast levels.
- The frame includes an inter-locking mechanism running on sliding bearings, locking the frame into the door in 6 locking points.
- Door leaf weight approx. 280 kg.
- Outward opening door only.

HARDWARE AND ACCESSORIES

- The multi-point mortise lock secures the door to the frame in 8 locking points, including four special hook locking mechanisms.
- High Security RB cylinder with improved cylinder protector, preventing drilling as well as forcing of the lock or the cylinder.
- Additional accessories available: hydraulic closer, electric strike, S&G combination lock.
- Multi-point locking mortise lock with Electronic monitoring function (lock \ un-lock) – optional.

BALLISTIC AND BLAST RESISTANCE

- Certified by H.P. White Labs in accordance with the standards and procedures of SD – STD – 01.01 revisions G (amended).
- Ballistic protection level: military rifle. The ballistic plate also meets the requirements of the UL 752 standard, protection level 4.
- Blast Resistance - The door was tested with a blast of 150psi and an impulse of 200psi/msec.

FORCED ENTRY RESISTANCE

- The door is certified by H.P. White Labs in accordance with the standards and procedures of SD – STD – 01.01 revisions G (amended).
- Forced entry protection level: 60 minutes.

THE DOOR FRAME

- The FE60 special frame may be concrete casted or welded to a steel forced entry resistant wall structure.
- The frame is made from 3mm thick hot dip galvanized steel sheets reinforced with interior anti-ballistic plates. The frame weighs approx. 100kg.
- The frame is assembled together with the door in the Rav-Bariach factory.

DOOR FINISHES

- PVC finish.
- Powder painted.
- 4 mm decorative panels.

STANDARD DOOR LEAF DIMENSIONS

- Height: 2,040 mm.
 - Width: 800 mm.
- (Other dimensions are available upon special order).



lockis pat-pend
cylinder inside



High resistant
hinges

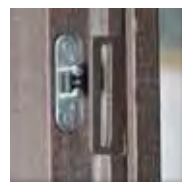

Inter - locking
mechanism



FORCED ENTRY RESISTANT DOOR | MODEL FE 60

TECHNICAL DRAWINGS

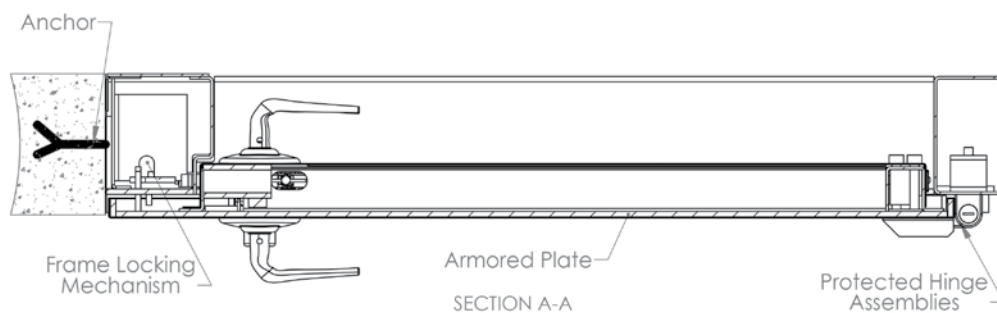
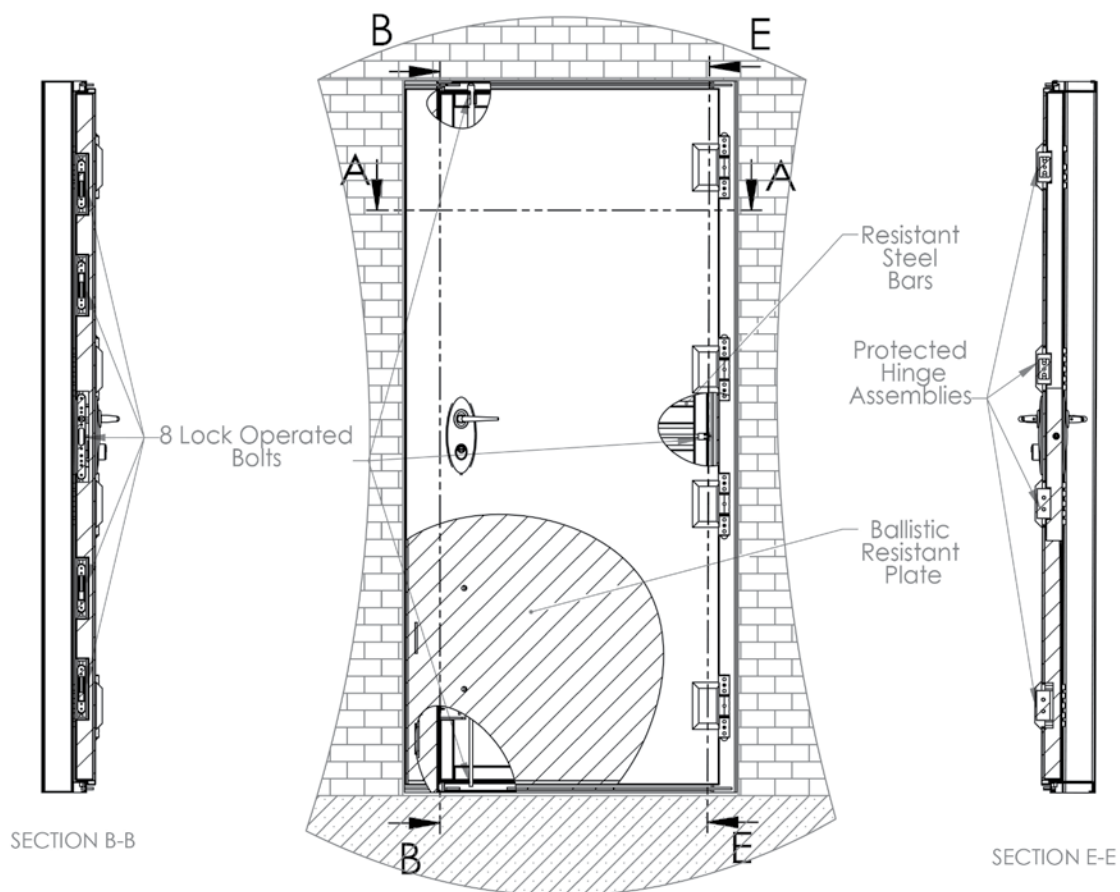

BULLET PROOF DOOR

MODEL 769

RB-DOORS specializes in the manufacturing of the highest quality security doors based on years of product development, knowhow and expertise. A broad range of security and advanced security doors are available suiting customers' different needs.

The bullet resistant door model 769 is manufactured by RB-DOORS compliant to the highest production standards. This High Security door includes an advanced locking system and provides the protection needed for advanced security, high defense level facilities.



TECHNICAL SPECIFICATIONS

GENERAL DESCRIPTION

- The door is made of two 1.25mm thick galvanized steel sheets, reinforced by horizontal steel bars set between the casing and the armor plate.
- RB's High security 4-way locking system with additional reinforcement mechanism.
- 4 heavy duty hinges.
- Telescopic bottom insert for door height adjustment.
- Door leaf thickness is 50 mm.
- Door weight is 120 kg - 150 kg.
- *Bullet resistant window - optional.

CERTIFICATION

- Ballistic resistant armor steel plate, tested according to UL 752 protection level 4-8.
- Ballistic resistant transparency tested according to DIN 52290 part 2, using an AK-47 rifle and M16.

HARDWARE AND ACCESSORIES

- RB's High security cylinder.
- Hardened drill resistant cylinder protector with a rotating disc.
- Security cover plates on both sides of the locking case.

FRAME

- Construction or cover frame.
- Bullet proof frame - optional.

DOOR FINISHES

- PVC finish.
- Powder painted.
- 4 mm decorative panels.

DIMENSIONS

- Max door Height: 2,300 mm.
- Max door Width: 1,200 mm.
- Available in Single and Double Leaf variants.

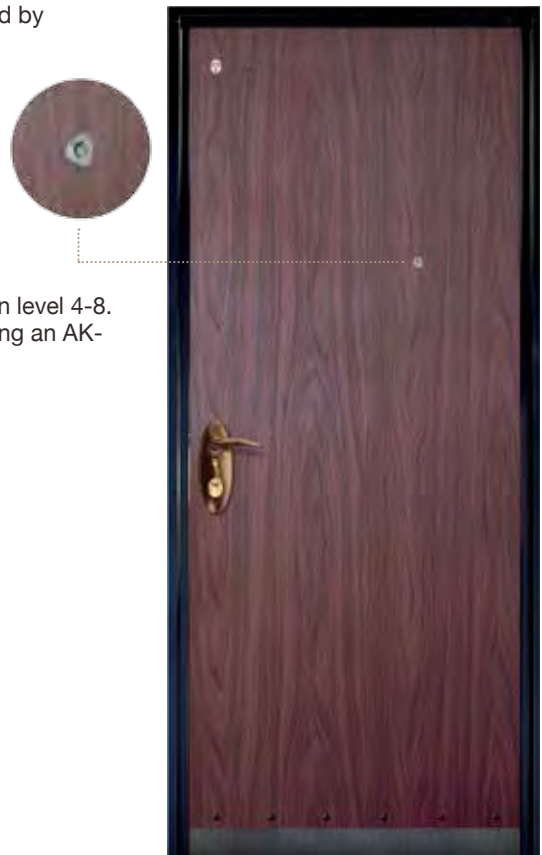

FORCED ENTRY RESISTANT DOOR | MODEL 769

DOOR FINISHES & DESIGNS

RAL COLOR CATALOG



PV CCOATING



SAMPLE OF DOOR DESIGNS



Additional Door finishes available

* The colors are for illustration purposes only. The final color may vary.

TECHNICAL DRAWINGS

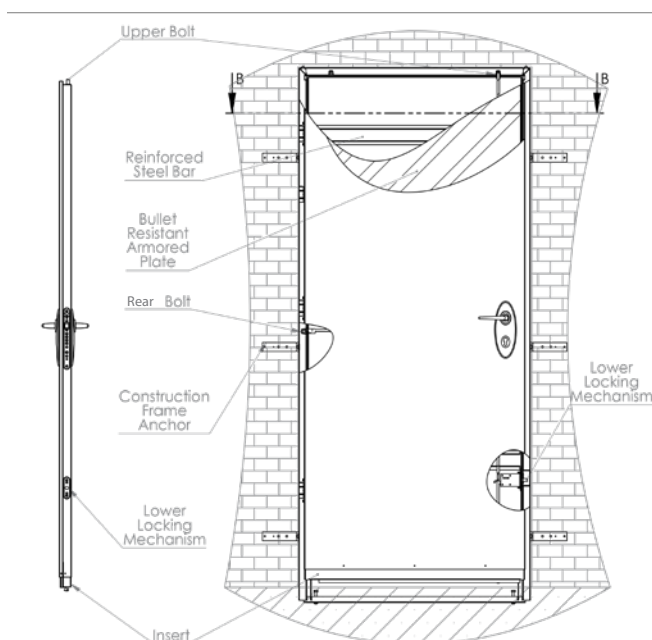

High Security
Multi Point
Locking System

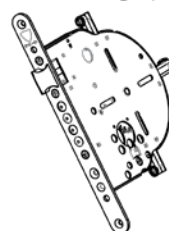

Lower
Locking
Mechanism

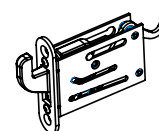

Elliptic Hardware

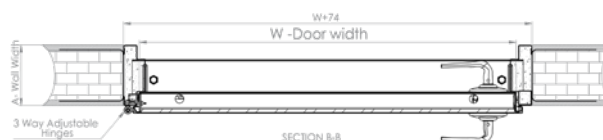
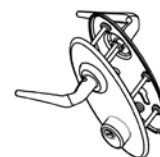

SINGLE/DOUBLE LEAF FIRE DOOR

30 MINUTE FIRE DOOR

Single or Double-leaf Fire Door for 30 min fire rating, meets with Israeli and International fire regulations, providing outstanding protection for various types of commercial and residential buildings, industries and institutions.

TECHNICAL SPECIFICATIONS

GENERAL DESCRIPTION

- Door leaf with two 0.8 mm thick galvanized steel casings and interior reinforcements.
- Intumescent gasket between door and frame.
- Fire rated hardware.
- Telescopic bottom insert for final height adjustment.

HARDWARE AND ACCESSORIES

- Anti - Panic Lock.
- Moveable lever door handles.
- Fixed handle, Panic bar or Push bar – optional.
- Hydraulic closer - optional.
- Door closing coordinator - for double door.

WINDOW DIMENSIONS (OPTIONAL)

- 600x400 mm.
- 820x170 mm.
- Round 440 mm diameter.

DOOR FINISH

- PVC finish.
- Powder coating.

DIMENSIONS

- Maximum door leaf height (without bottom insert) – 2200 mm.
- Maximum door frame height – 2400 mm.
- Maximum moveable door width – 1140 mm.
- Maximum fixed door width – 1140 mm.
- Maximum double-leaf door frame width – 2360 mm.

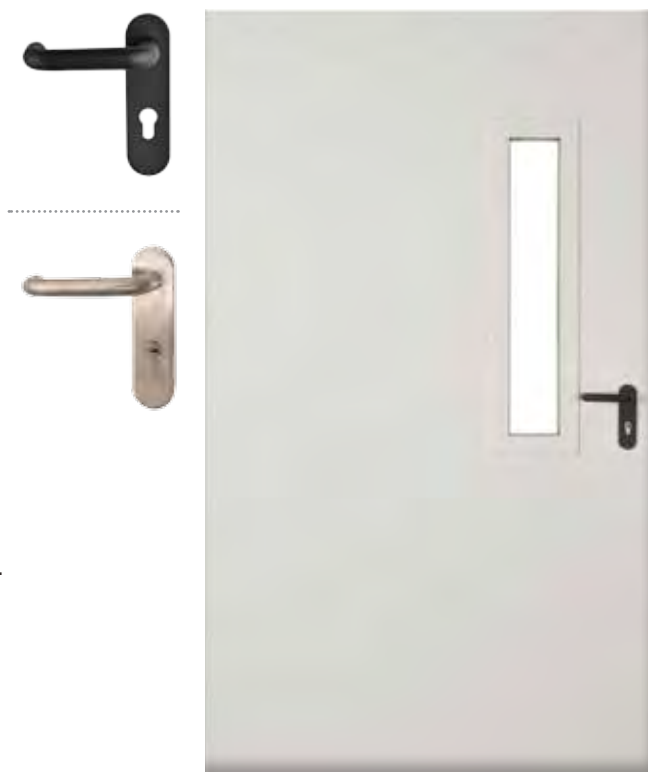

DOOR FINISHES

RAL Color Catalog			PVC Coating	Window Options		
3104	9001	9016	pvc-13	Ø 440	170X820	400X600
				1400-1500mm	1400-1500mm	1400-1500mm
5103	MR09	9005	pvc-19			
7126	MR10	2030	pvc-40			

Additional door finishes available

* The colors are for illustration purposes only. The final color may vary.



SINGLE/DOUBLE LEAF FIRE DOOR | MODEL FW30

TECHNICAL DRAWINGS

Single leaf Door

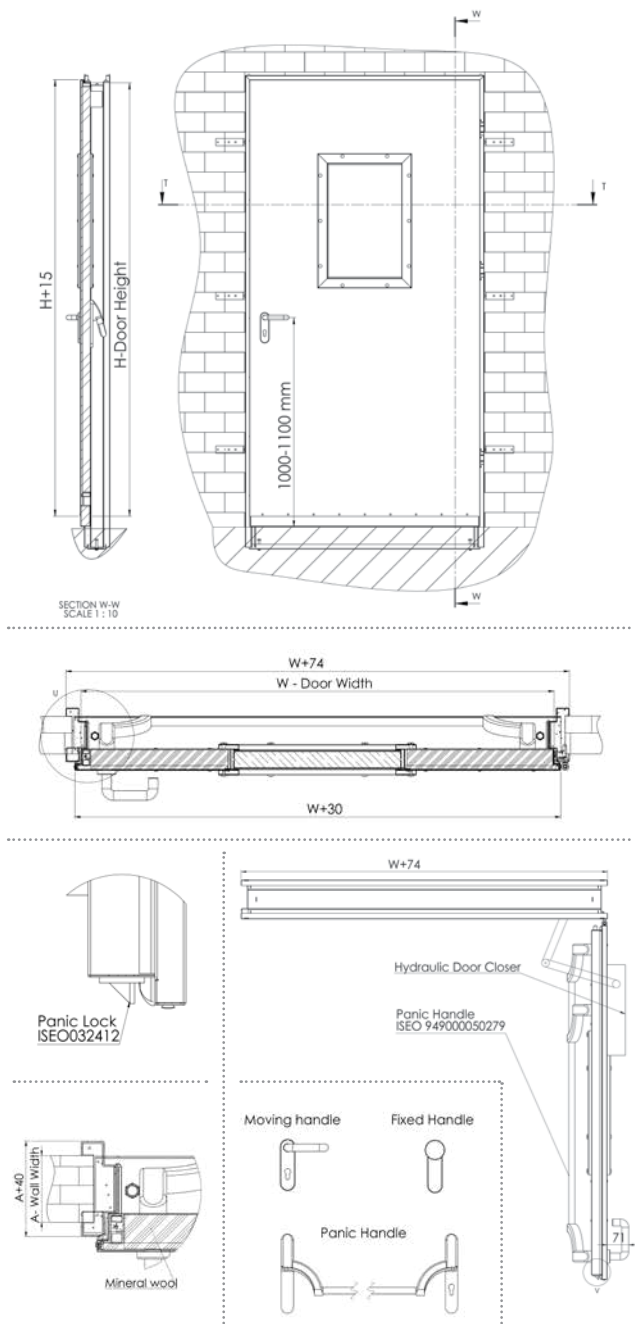

Double leaf Door

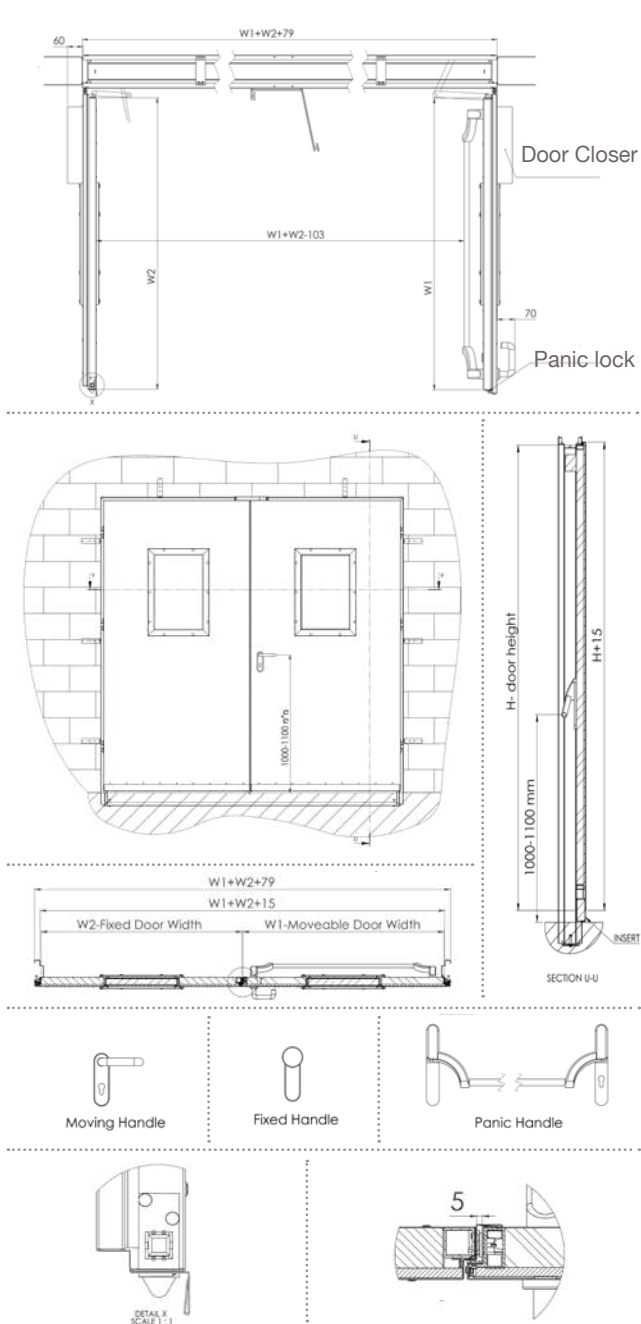

SINGLE/DOUBLE LEAF FIRE DOOR

60 MINUTE FIRE DOOR

The single-leaf Fire door model for 60 minute fire rating door meets with Israeli and International fire regulations, providing outstanding protection and safety for various types of industries, facilities, storerooms and stairwells.

TECHNICAL SPECIFICATIONS

GENERAL DESCRIPTION

- Door leaf with two 0.8 mm thickness galvanized steel casings and interior reinforcements.
- Intumescent gasket between door and frame.
- Fire rated hardware.
- Telescopic bottom insert for final height adjustment.

HARDWARE AND ACCESSORIES

- Fire rated lock.
- Moveable lever door handles.
- Fixed handle – optional.
- Hydraulic closer - optional.

WINDOW DIMENSIONS (OPTIONAL)

- 600x400 mm.
- 820x170 mm.
- Round 440 mm diameter.

DOOR FINISH

- PVC finish.
- Powder coating.

DIMENSIONS

- Maximum door leaf height: 2470 mm.
- Maximum door leaf width: 1120 mm.
- Maximum frame dimensions: 2600X1200 mm.



DOOR FINISHES

RAL Color Catalog



PVC Coating



Window Options

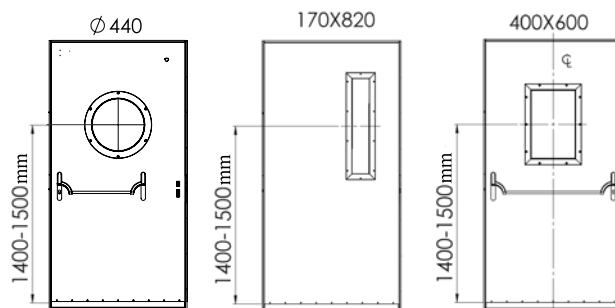

Additional door finishes available

* The colors are for illustration purposes only. The final color may vary.



SINGLE/DOUBLE LEAF FIRE DOOR | MODEL FWB

TECHNICAL DRAWINGS

PLASTIC HANDLE



AXIS

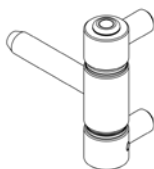

INSERT

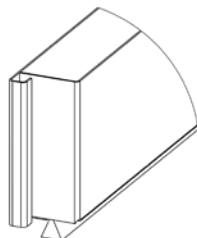

DETAIL C

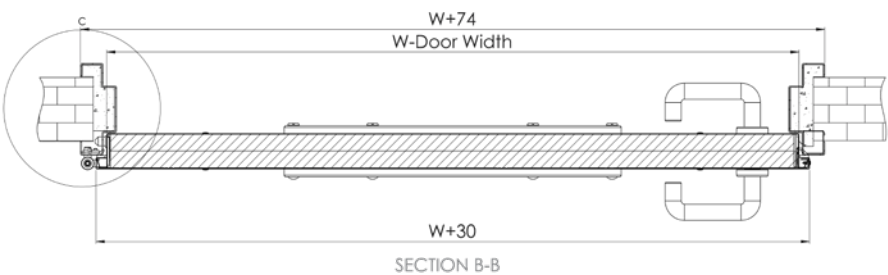
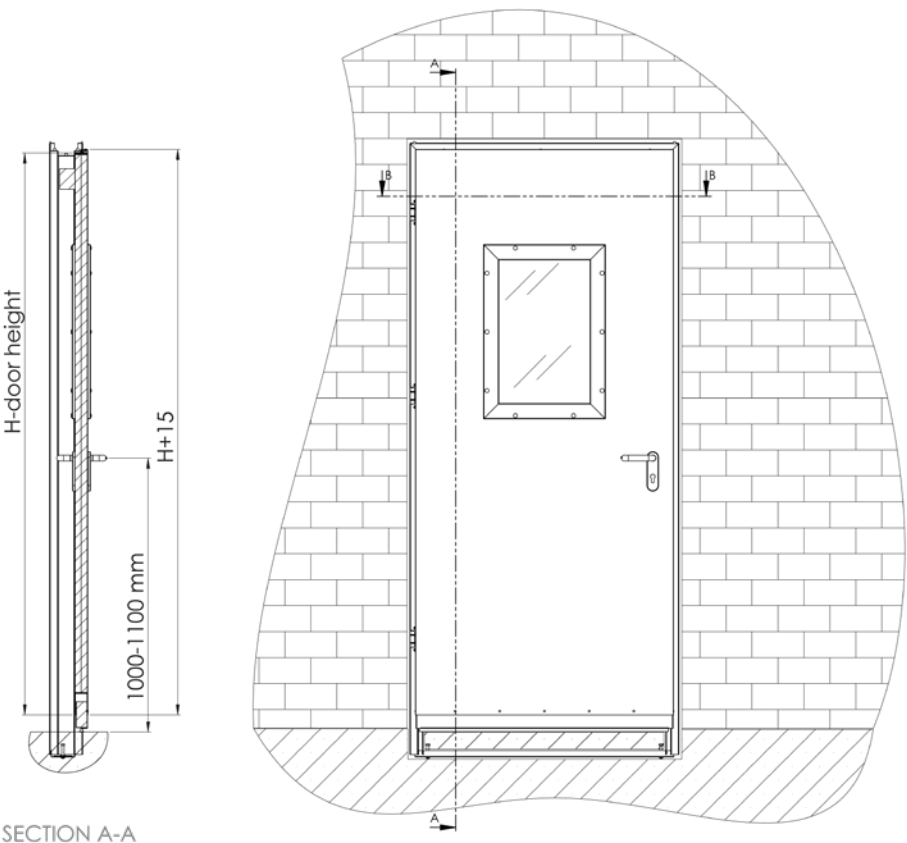
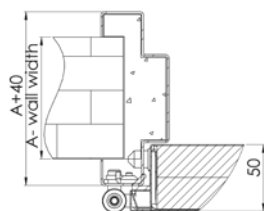

SINGLE/DOUBLE LEAF FIRE DOOR

MODEL FW90 | 90 MINUTE FIRE DOOR

Acoustic and Fire door model FW90, is a 90 minute fire rated door meeting the American (UL 10C), European and Israeli standards requirements. This advanced fire door is available with construction, cover or acoustic frame and provides outstanding protection and safety for various types of commercial and residential facilities, institutions and industries.

TECHNICAL SPECIFICATIONS

GENERAL DESCRIPTION

- The door leaf is made of two 0.8 mm galvanized steel sheets, reinforced by an internal profile structure. There are no welding points on the door - increased corrosion resistance.
- The door is equipped with a telescopic bottom insert for door height adjustment.
- Double layered door leaf filling - high density rock wool and fire resistant gypsum.
- Peripheral fire and smoke resistant gasket with intumescent core is attached to the door leaf edge.
- Door leaf thickness is 50 mm.

HARDWARE AND ACCESSORIES

- Available with stainless steel fixed handle, or with moveable handles.
- Door closer (optional).
- Anti - Panic lock.
- Door coordinator for double leaf door- optional.
- Panic bar - optional.

WINDOW DIMENSIONS (OPTIONAL)

- 600x400 mm.
- 820x170 mm.
- Round 440 mm diameter.

DOOR FINISH

- PVC finish.
- Powder coating.

DIMENSIONS

- Maximum door leaf height (insert height not included) – 2,400 mm.
- Maximum door frame height – 2,500 mm.
- Maximum moveable door width – 1,300 mm.
- Maximum fixed door width – 1,300 mm.
- Acoustic rating for FW90 door with Acoustic Frame
- Double door - 38 dB*
- Single door - 41 dB*

*Weighted sound reduction index – Rw



DOOR FINISHES

RAL Color Catalog



PVC Coating



Window Options

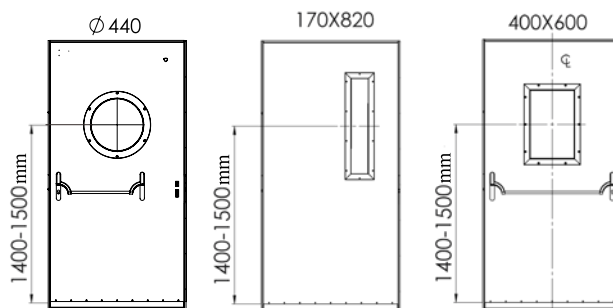

Additional door finishes available

* The colors are for illustration purposes only. The final color may vary.





STEEL STOREROOM & INDUSTRIAL DOORS

451 | 452 | 455 | 456

TECHNICAL SPECIFICATIONS

GENERAL DESCRIPTION

- Steel door made of 1.25/0.8 mm galvanized steel casings, with or without a surrounding rubber seal on edges and Telescopic bottom insert for easy door height adjustment. Suitable for storerooms, ventilation rooms, electric rooms and general facilities.

DOOR LEAF DIMENSIONS MODELS 452 & 451

- Width: from 880 to 1100 mm in increments of 20 mm
- Height: ranging from 1820 mm and up to 2400 mm (not including insert height)

DOOR LEAF DIMENSIONS MODELS 456 & 455

- Width: from 300 to 860 mm in increments of 20 mm
- Height: ranging from 1820 mm and up to 2400 mm (not including insert height)

DOOR FRAME

- Maximum Height: 3000 mm
- Construction Frame models: 800, 801

OPENING DIRECTIONS

- Right/left
- Outwards/inwards opening

WINDOW OPTIONS

- Smoke Shutter Window (upper/lower/entire door/upper and lower)
- Vent slats (louver) (upper/lower/ entire door/upper and lower)

LEAF INSERT

- Standard height: 105 mm, 130 mm height by special order

FINISHES

- Textured or granular Electrostatic Paint Finish, available in various shades from the • Rav Bariach colour catalogue
- PVC Finish
- Galvanized



DOOR SIZES CHART

MODEL DESCRIPTION	WIDTH OF TIN	AVAILABLE WIDTH MEASUREMENTS	SEAL
Storeroom Steel Door 455	0.8 mm	300-860	With seal
Storeroom Steel Door 456	0.8 mm	300-860	Without seal
Storeroom Steel Door 452	1.25 mm	880+	With seal
Storeroom Steel Door 451	1.25 mm	880+	Without seal



STEEL STOREROOM & INDUSTRIAL DOORS

TECHNICAL DRAWINGS

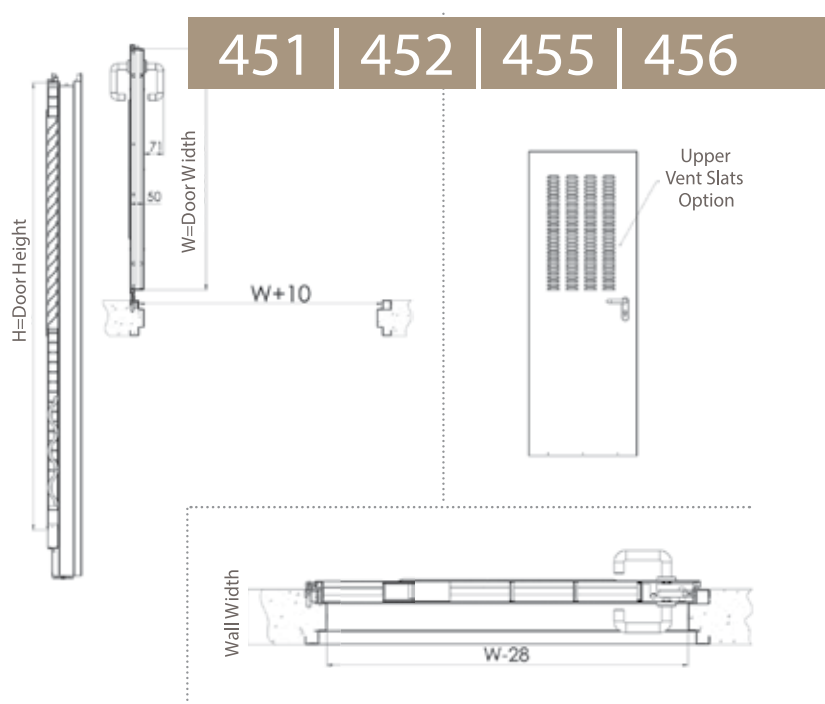
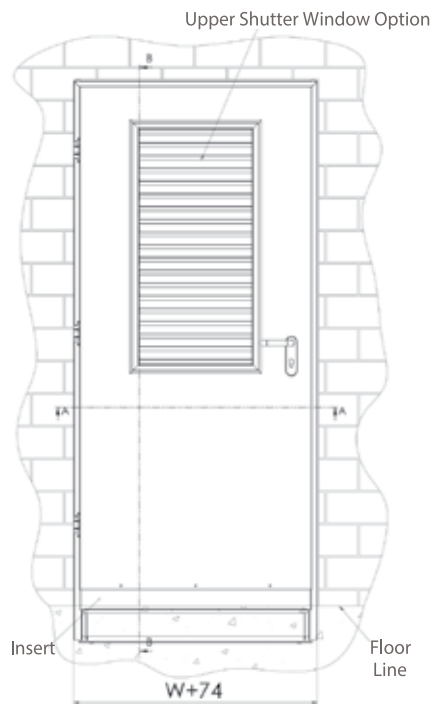

INTERIOR DOOR SUNDOOR

MODEL B

Sundoor door model collection is designed for use in offices, as interior doors, for public buildings or where necessary the use of high durable interior doors. The doors are manufactured under strict control of the Israel Standards Institute.

TECHNICAL SPECIFICATIONS

GENERAL DESCRIPTION

- 0.6mm Coated steel door with peripheral fingerjoint wood framing, polyurethane injected filling and aluminum bottom edge to protect the door.
- 2 Heavy duty hinges
- 101 type lock
- Sundoor hardware - nickel finish
- Door stopper

DIMENSIONS

- Door height(H): 2007/2055/2070 mm
- Door width (W): 700/ 710/ 720/ 740/ 760/ 780/800/ 810/ 820/ 840/ 861/ 880/900/ 920/ 940/ 960/ 980 mm
- Opening direction - right/left opens outward and inward

FINISH

- Variety of PVC shades or pre-painted finish



DOOR FINISHES

PVC Coating



white



פיקאן

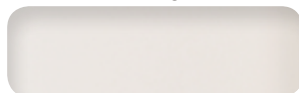

pearl



מורן



וונגה

* The colors are for illustration purposes only. The final color may vary.



INTERIOR DOOR SUNDOOR

MODEL B

TECHNICAL DRAWINGS

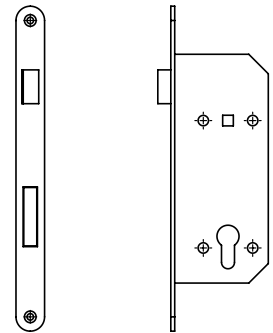
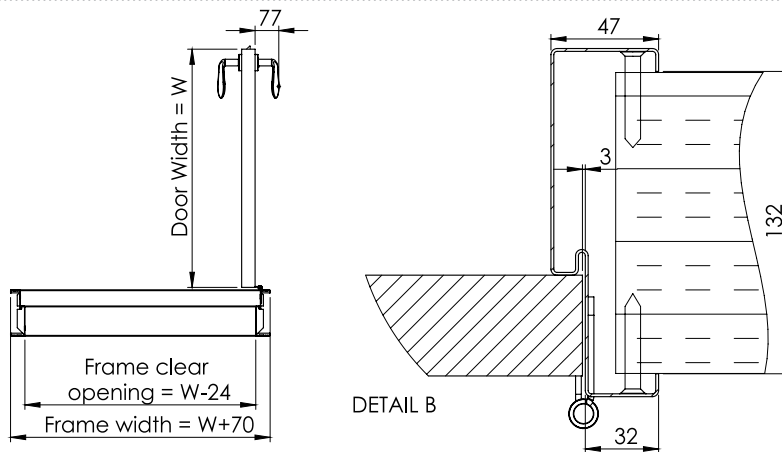
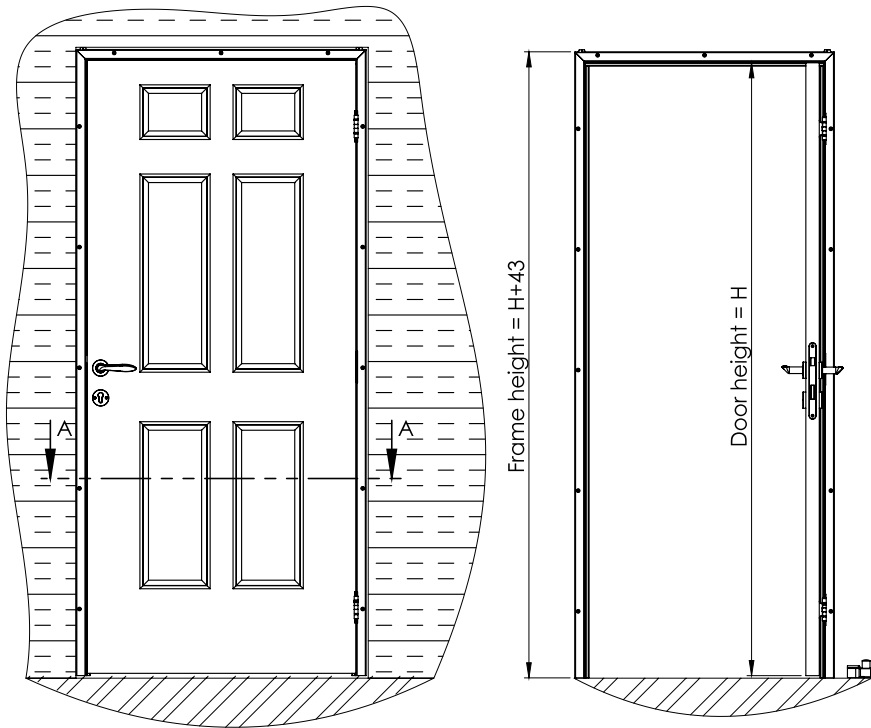

101 type lock

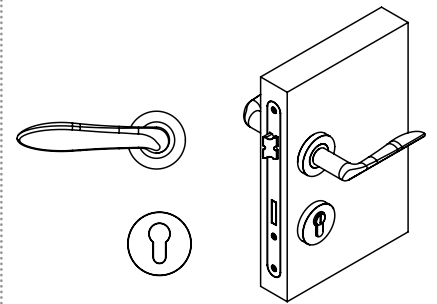

Sundoor hardware

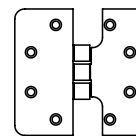

Heavy Duty hinges

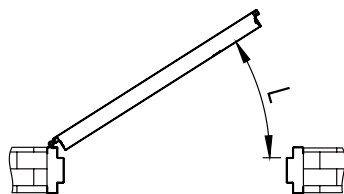

Left door

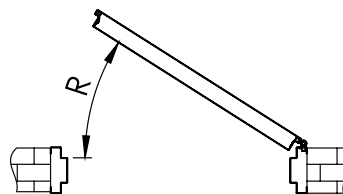

Right door

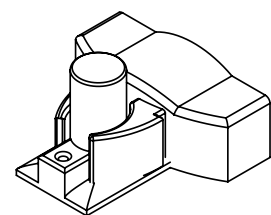

Door stopper



Comments

[illegible]



RB-DOORS
INNOVATIVE SECURITY

**For your assurance of maximum security and the highest quality,
choose only original products by rb-doors.**

Abuja office:

No.11, Thaba Tseka Crescent, Wuse 2 Abuja
Tel: 09-291-7524, 09-291-9947, 0909 909 5777, **0809 999 2856**, 0908 784 6893,
0908 784 6892

Lagos Office:

44 Opebi Road, Ikeja, Lagos
Tel: 01-454-2485, 0909 999 9663, 0909 999 9664, 0909 999 9665, 0809 999 3247

Ibadan Office:

Alpha&Omega complex
Plot XVII, Block XIX, Queen Elizabeth 2 Road, Opposite Asunle bus stop, Mokola Layout
Ibadan, OYO State
Tel: **0809 999 2846**, 0809 999 2847

Rav-Bariach (08) Industries Ltd.

POB 3032, Southern industrial Zone, Ashkelon, Israel

www.rb-doors.com

© Copyright, 2017 Rav-Bariach (08) Industries Ltd. All rights reserved
RB reserves the right to make changes and improvements to any products described in this catalogue without prior notice.

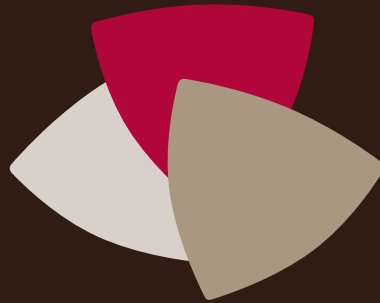

www.gsl-ng.com



RB-DOORS